

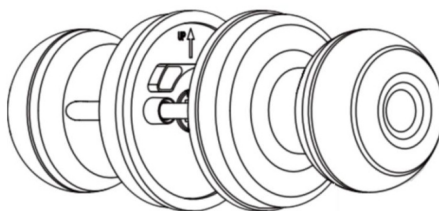

Knob Lock with Fingerprint

Model No.: K01



Components list

No.	Components	Quantity		No.	Components	Quantity
1	Exterior Knob	1		5	Striker Plate	1
2	Interior Knob	1		6	Striker Box	1
3	Latch	1		7	Screw A	4
4	Key	2		8	Screw B	2

Please check the above components carefully to make sure all items have been received. If any items are missing, please contact Customer Service (See page for contact information).

Please read this manual carefully before installing and operating!

Tools Required

- (1) Phillips screwdriver
- (2) Tape measure

Installation Guide

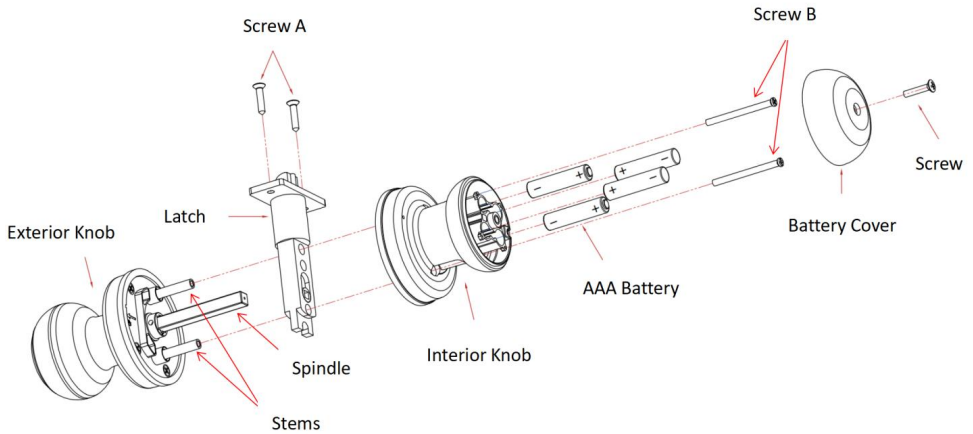

1. Check The Door's Dimension

- (1) Measure to confirm the thickness of the door is between 1-3/8" and 2-1/8" (35~54mm).
- (2) Measure to confirm the diameter of the hole in the door is 2-1/8" (54mm).
- (3) Measure to confirm the backset (as shown below) is either 2-3/8" (60mm) or 2-3/4"(70mm).
- (4) Measure to confirm the diameter of the hole in the door edge is 1" (25mm).

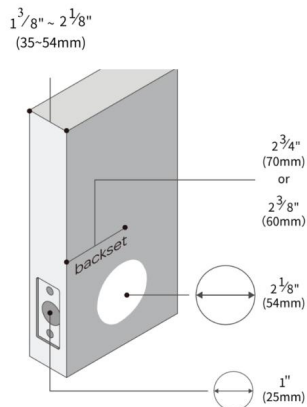

2. Install Latch and Strike

(1) Set the Latch backset to 60mm(2-3/8") or 70mm(2-3/4") to fit your door hole.

(2) Insert the Latch into the door hole, and tighten Screw A to fix the Latch. Install Striker Box and Striker Plate also with Screw A into the door frame.

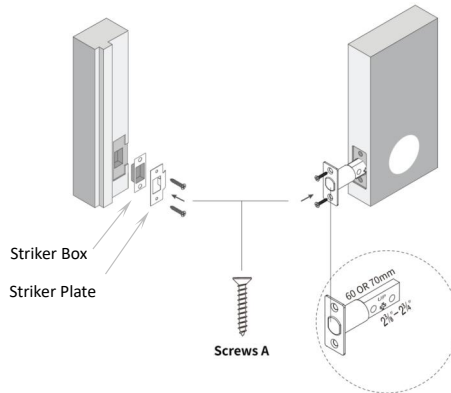

3. Install Exterior Knob & Interior Knob

(1) Install Exterior Knob (the lock body with Spindle and two Stems) from outside of your door and make sure the Spindle and Stems go through the three holes of the Latch.

(2) Insert Interior Knob by aligning the two stems with the screw holes, connect the wire by inserting the connector into the socket, and tighten Screw B.

4. Install Batteries

(1) Loosen the the screw to remove the battery cover in the Interior Knob.

(2) Install 4 AAA batteries and tighten the screw to fix the battery cover.

PLEASE DO NOT USE LITHIUM BATTERIES OR RECHARGABLE BATTERIES.

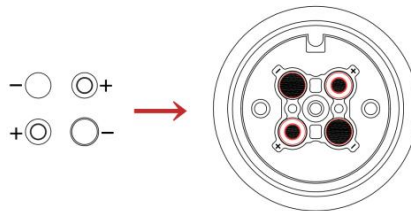

APP Operation Guide

1. Scan the below QR code to download the Tuya Smart APP, or search “Tuya Smart” in the APP Store(iOS) or Google Play(Android) to install the APP.



Scan to download Tuya Smart



2. Register an account

① Press “Agree” and “Log In” on the login screen.

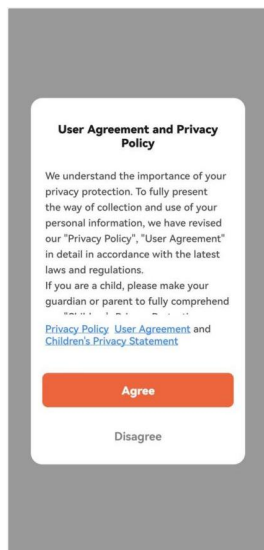

② Choose the country where the lock is being used, enter your Email address to get verification code, set password, select permissions and press “Go to APP” to finish the registration.

<

Register

United States of America

Email Address

☐ I AgreePrivacy Policy User Agreement and Children's Privacy Statement

<

Enter Verification Code

A verification code has been sent to your email [9753@163.com Resend (51s)]

Didn't get a code?

88 I The I'm

1	2	3	-
4	5	6	,
7	8	9	⌂
.	0	English (USA)	↩

<

Set Password

Password

Use 6-20 characters with a mix of letters and numbers

To provide you with better services, we request the following permissions:



When you use this App, we will collect necessary information (including statistical data, network usage data, application crash events) in order to monitor the performance of the App.

Data Analysis

☐ Allow us to collect data related to product usage. If you disable permissions, basic functions are still available.

Personalization

☐ Allow us to recommend content through ads and notifications. If you disable it, we won't send what may interest you.

Go to App

3. Add a lock

- ① Keep your phone close to the lock, touch the fingerprint sensor of the lock, and press the “Add Device” on the screen.

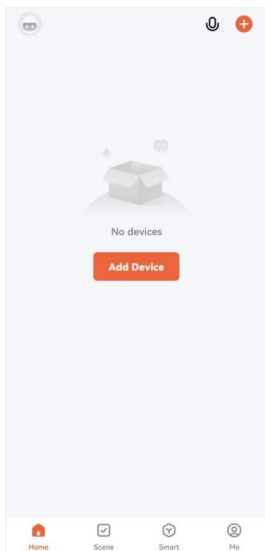

- ② Continue and tap “ALLOW ONLY WHILE IN USE”.

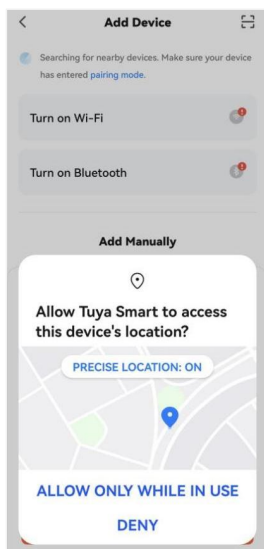
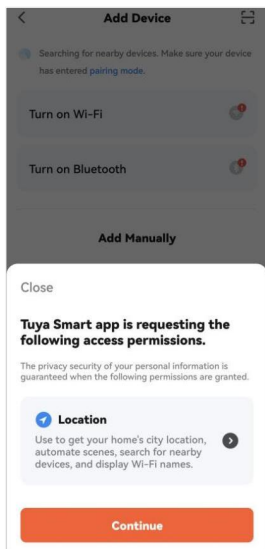

③ Allow to turn on the Bluetooth to connect the lock.

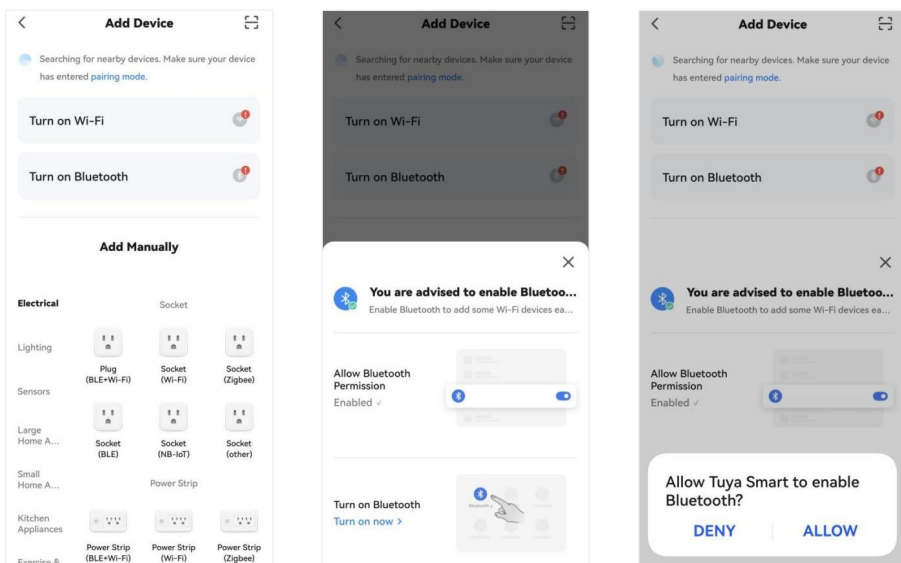

④ Tap "Add" and "+" to finish adding the lock.

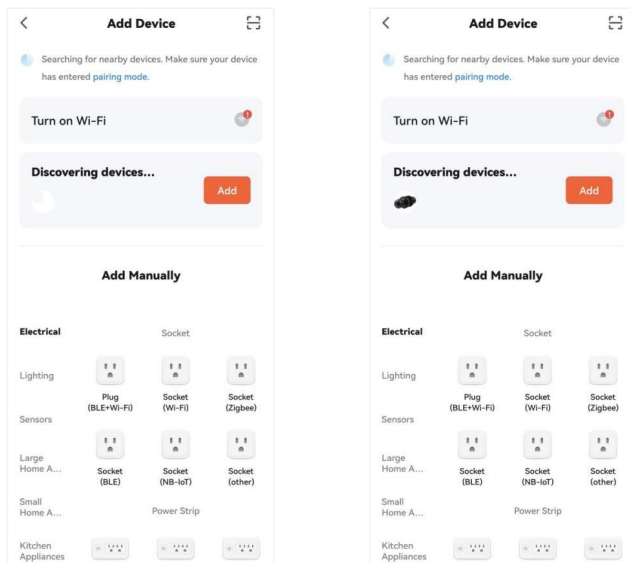

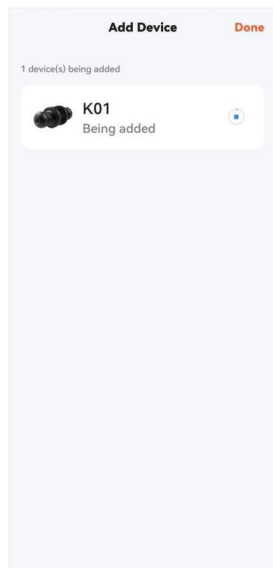
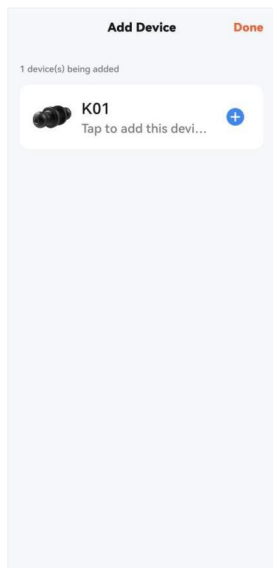

- ⑤ Press “✎” to rename the lock if needed, and the lock is ready for use via APP.

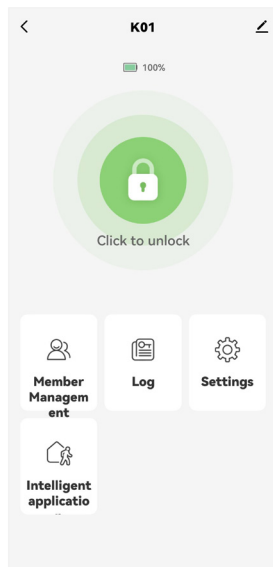
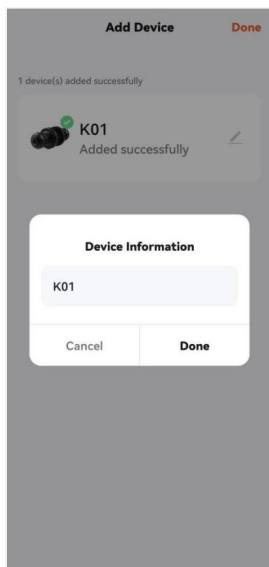
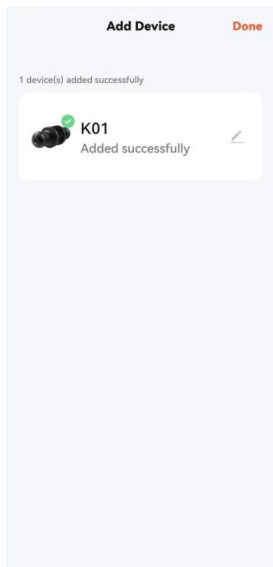

4. Lock or unlock via APP

① Click the lock icon “” to unlock the door

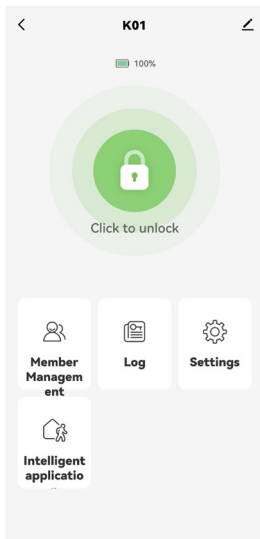

② Click the lock icon “” to lock the door

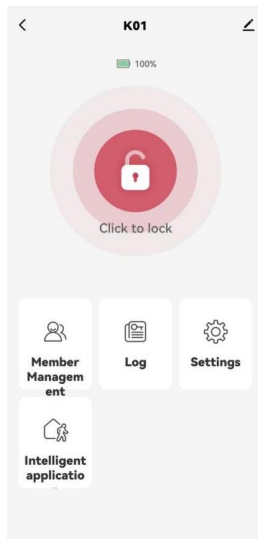

5. Member management and fingerprints input

① Select “Member Management” on the screen ② Tap “+” to add more members

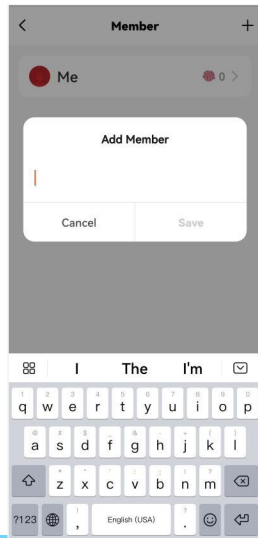
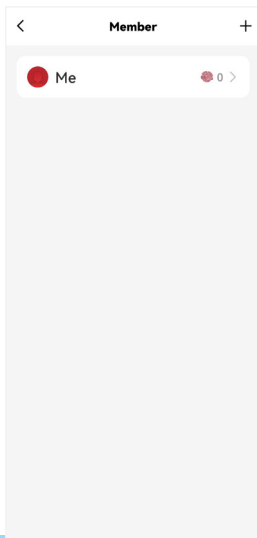
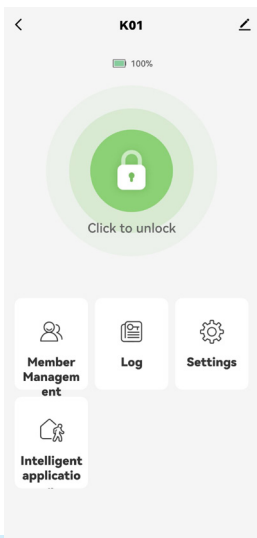

③ Press “Me” and follow the instructions to add fingerprint

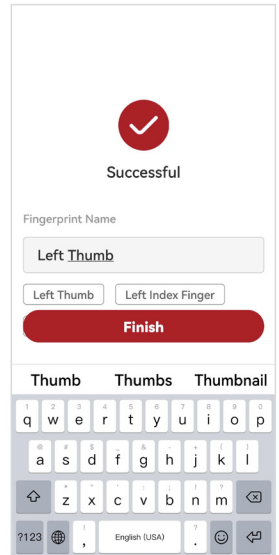
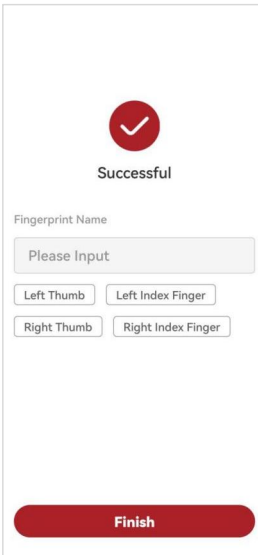
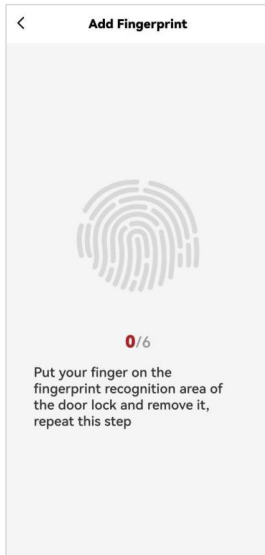
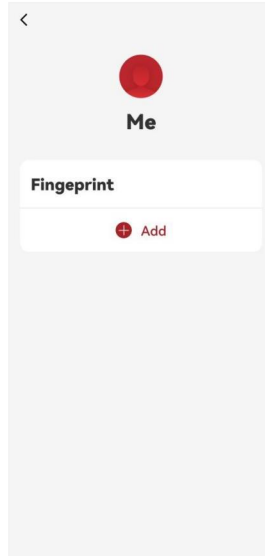
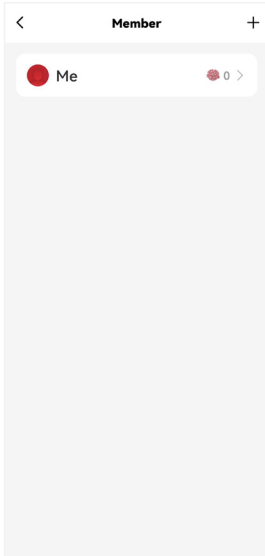

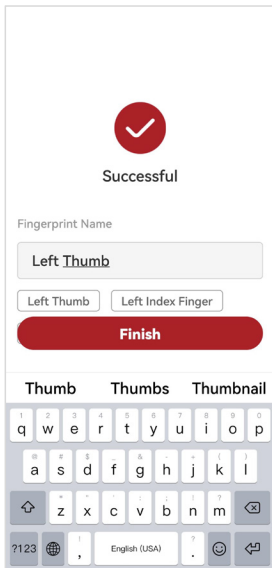

6. Check log information

① Select “Log” on the screen

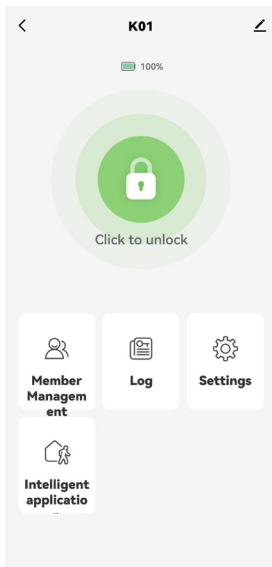

② Press “Time”, “Operate” or “User” to review the history of the lock’s working

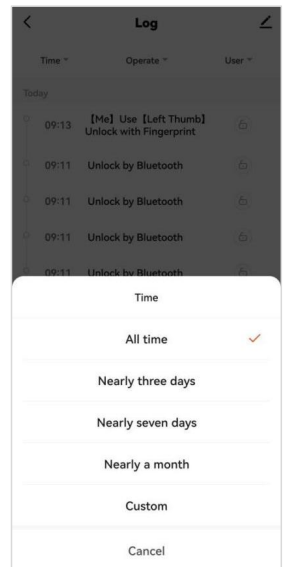



7. Settings

- ① Select “Settings” on the screen to turn on/off “Auto Lock” or set up the time delay

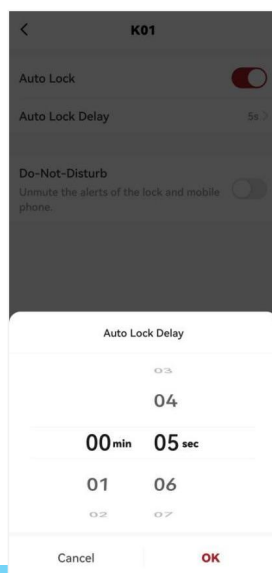
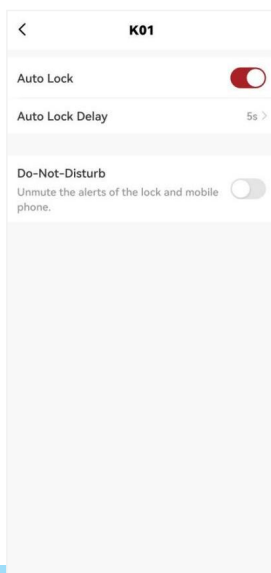
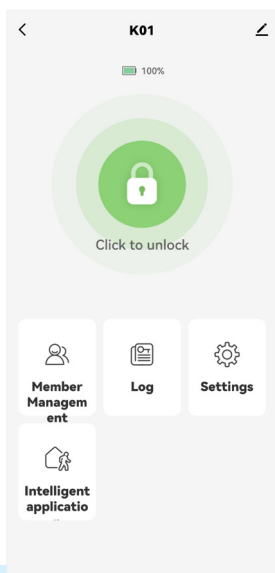

- ② Turn on/off the “Do-Not-Disturb” and set up the time period according to your preference.

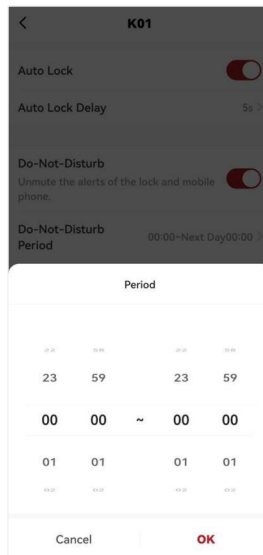
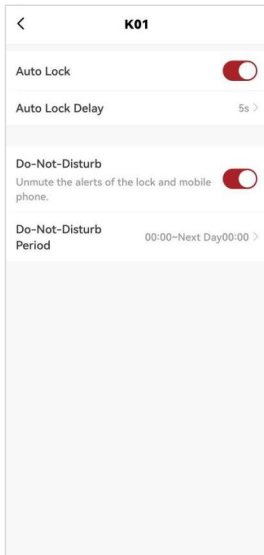

8. Intelligent Application

- ① Select “Intelligent application” on the screen, choose the scenes you prefer to set up intelligent interactions.

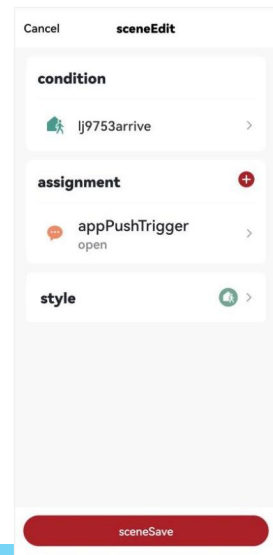
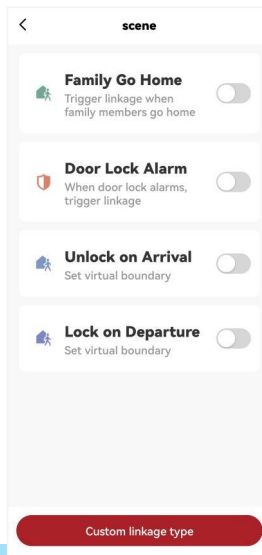
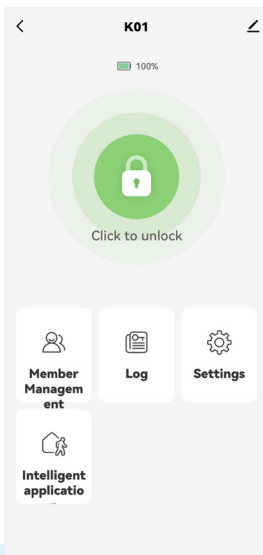

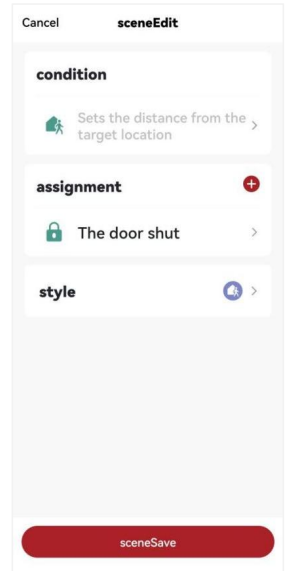
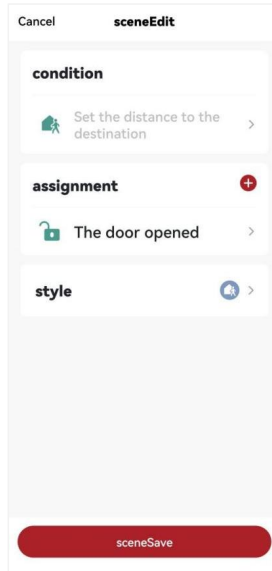
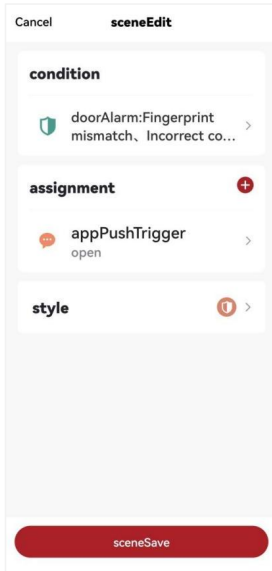

9. Device information setup

- ① Press the icon “✎” on the top right corner of the screen to check and set up the relevant information

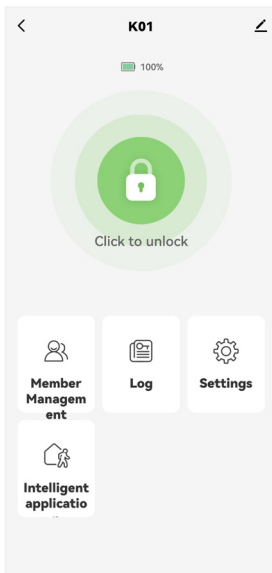

10. Personal information setup

- ① Press the icon “” on the top left corner of the screen to set up personal information like profile photo, nickname and time zone.

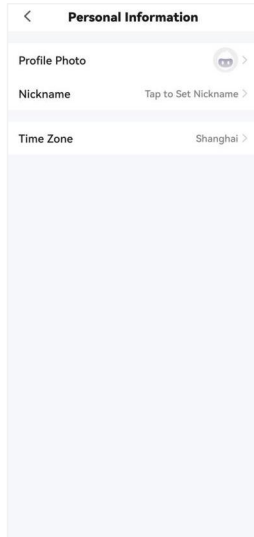
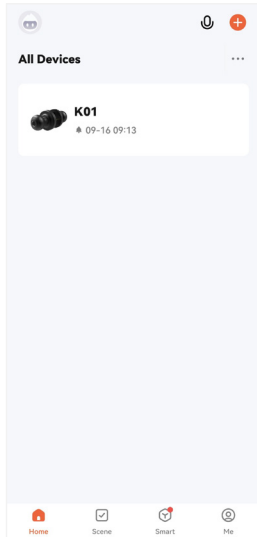

11. Add new device or create new scene

- ① Press “” on the top right of the screen to add more devices or create more scenes

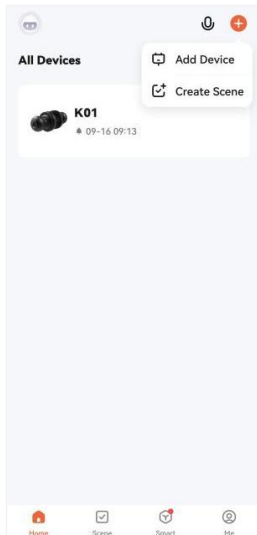

12. Create scenes

① Select “Scene” on the screen, and choose “Automation” or “Tap-to-Run” to create scenes

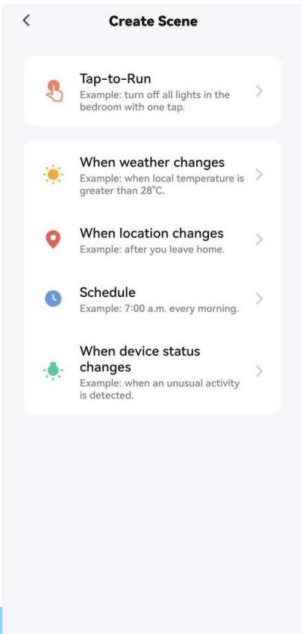
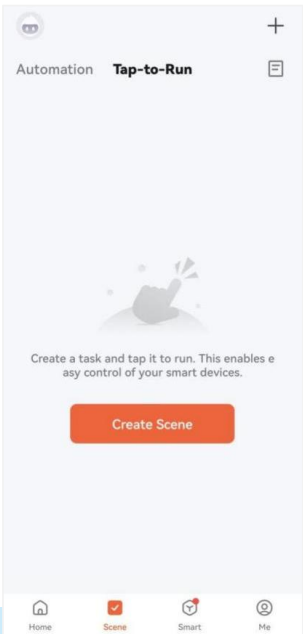
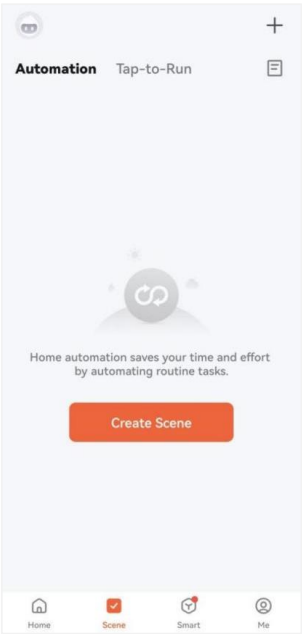
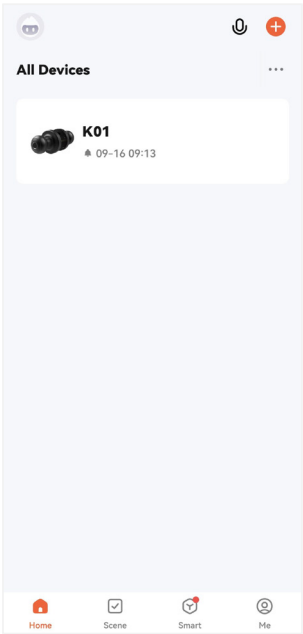

13. Smart functions setup

- ① Select “Smart” on the screen, and set up the smart functions you prefer

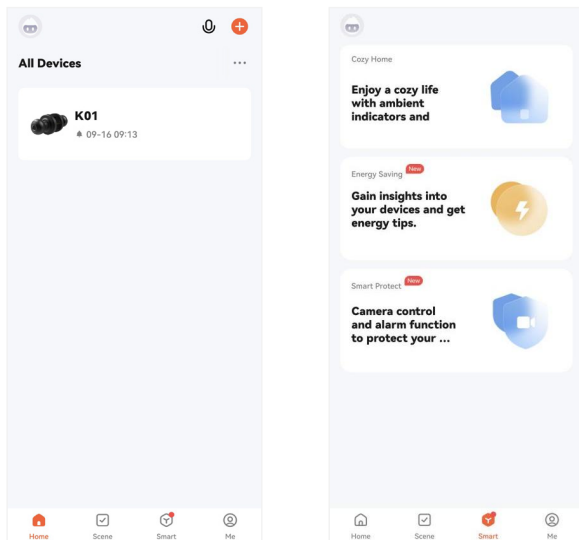

14. Check personal account information

- ① Select “Me” on the screen, and you can set your nickname, choose your third-party voice, set up your home information, check messages or check FAQ related to the APP

Third-party Voice Services

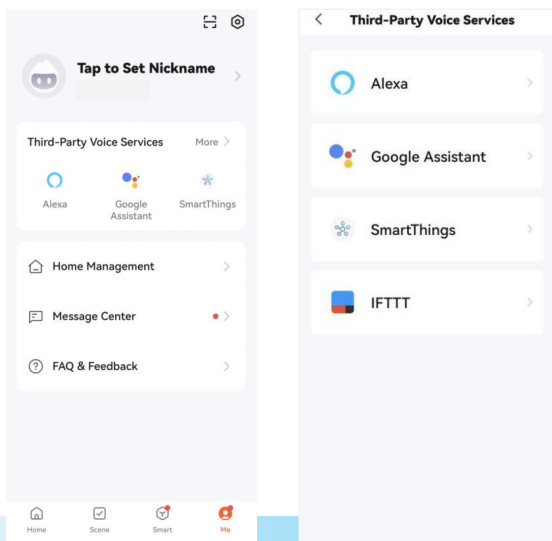

Home Management

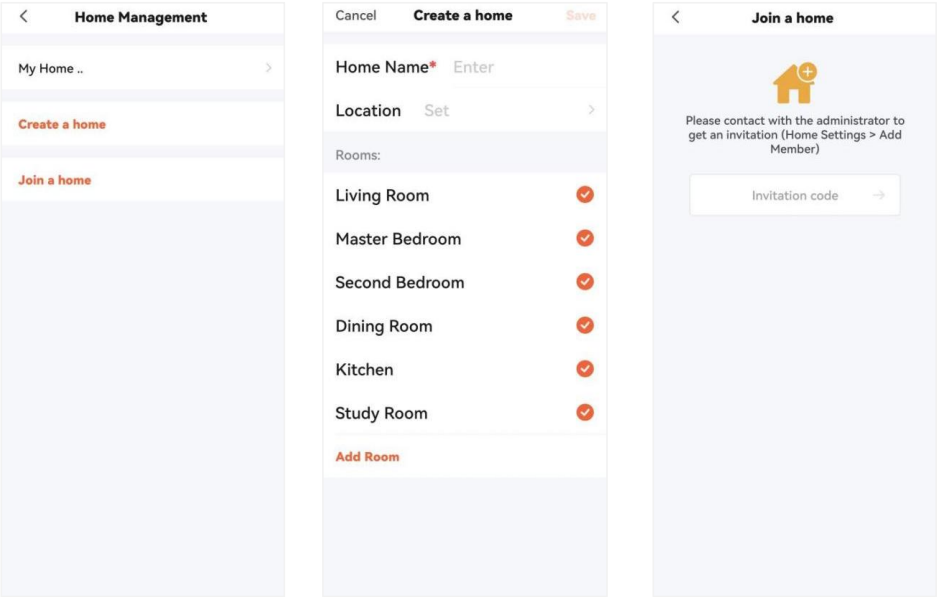

Message Center

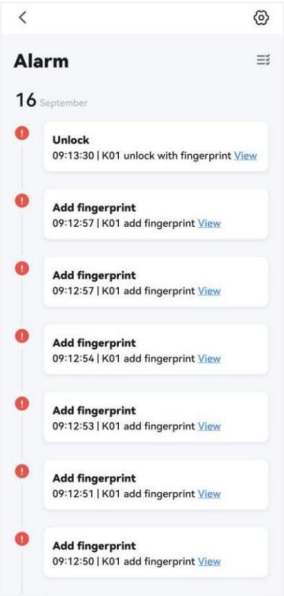
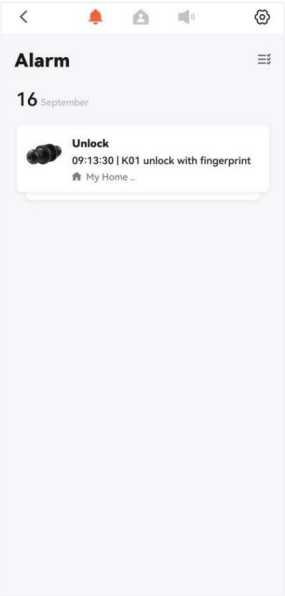

FAQ & Feedback

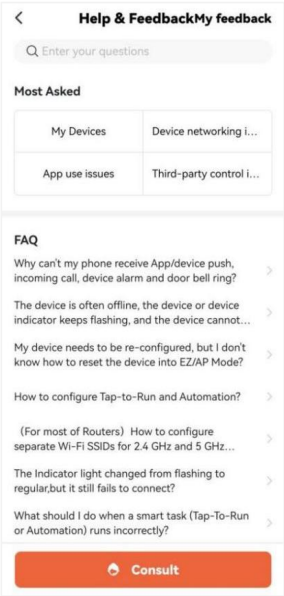

15. Use camera to scan

- ① Press the icon “” on the top right corner of the screen to scan if needed

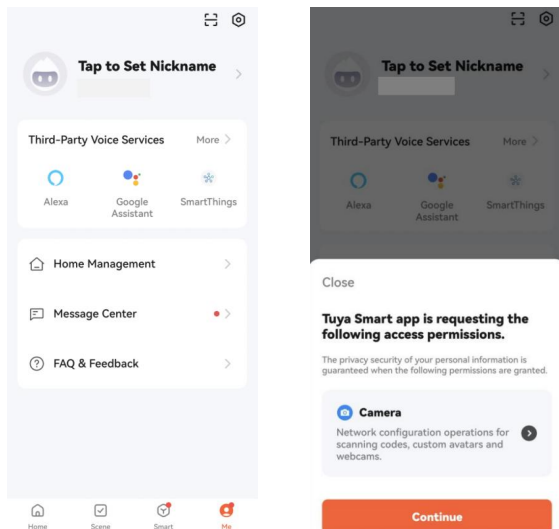

16. Other settings

- ① Press the icon “” on the top right corner of the screen to review other settings

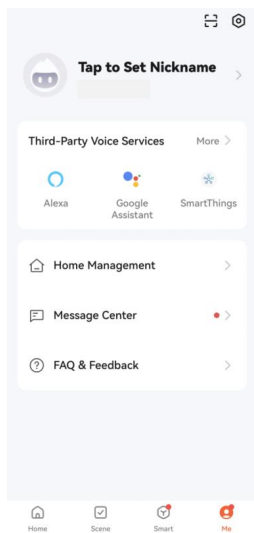

Personal Information: to set up profile photo, nickname and time zone

Account and Security: to set up region, email address, change password, fingerprint ID, pattern lock or delete account

Device Update: to update the device

Sound: to turn on/off the sound of operation

App Notification: to turn on/off notifications and alarms, etc.

Scan device in homepage: to turn on/off scan function in the homepage

Add Device Automatically: to allow or not allow to add device automatically

Dark Mode: to turn on/off dark mode

Temperature Unit: to set up the unit of temperature

About: more information about the APP related to log, version and updates, etc.

Privacy Settings: to give permissions of data analysis, personalization, location, access storage, camera and microphone

Privacy Policy Management: information about privacy policy, user agreement, children's privacy statement and to export personal information if needed

Network Diagnosis: to diagnose the network problems

Clear Cache: to clear the cache data

Operation Guide

(1) Key to unlock

Press the screw in the back of the Exterior Knob, and the fingerprint head cover will come out for you to easily pull and turn.

Pull out the fingerprint head cover, insert the key and turn the key 90° to unlock, then turn the Exterior Knob to open the door.

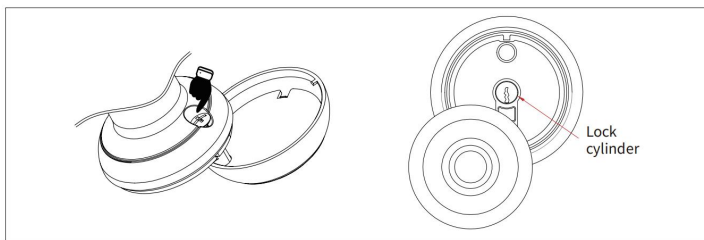

(2) Low power indication

After being unlocked by fingerprint or APP successfully, the fingerprint head flashes green and then flashes red, it is time to install new batteries.

(3) Restore factory settings

Use pin to press the small reset button in the Interior Knob for 5 seconds, the buzzer will beep once and the fingerprint head will flash green, and the lock has been reset to factory settings.

Contact Us First! Do Not Return To Store!

Email:
Toll Free:
Address:

FCC warning

Any Changes or modifications not expressly approved by the party responsible for compliance could void the user's authority to operate the equipment.

Note: This equipment has been tested and found to comply with the limits for a Class B digital device, pursuant to part 15 of the FCC Rules. These limits are designed to provide reasonable protection against harmful interference in a residential installation. This equipment generates uses and can radiate radio frequency energy and, if not installed and used in accordance with the instructions, may cause harmful interference to radio communications. However, there is no guarantee that interference will not occur in a particular installation. If this equipment does cause harmful interference to radio or television reception, which can be determined by turning the equipment off and on, the user is encouraged to try to correct the interference by one or more of the following measures:

- Reorient or relocate the receiving antenna.
- Increase the separation between the equipment and receiver.
- Connect the equipment into an outlet on a circuit different from that to which the receiver is connected.
- Consult the dealer or an experienced radio/TV technician for help.

This device complies with part 15 of the FCC Rules. Operation is subject to the following two conditions: (1) This device may not cause harmful interference, and (2) this device must accept any interference received, including interference that may cause undesired operation.