

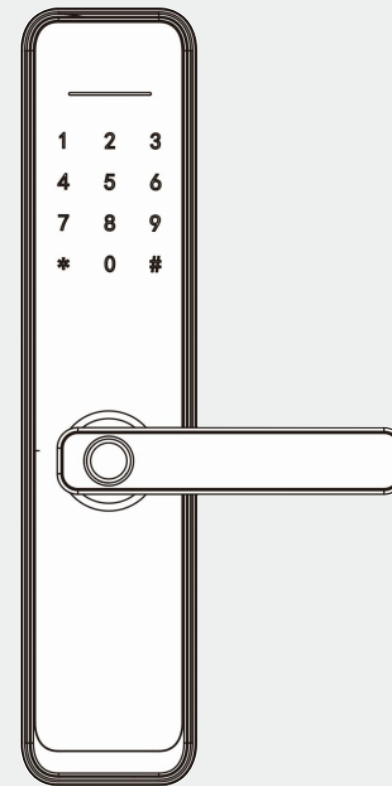

Smartlock Manual

A2 / A2C / A3 / A5 / A8-P



NOTICE:

1. Please read this instruction sheet before used.
2. Please take key with you or put it outside the room.

Installation guide of double latches mortise

1. Accessory

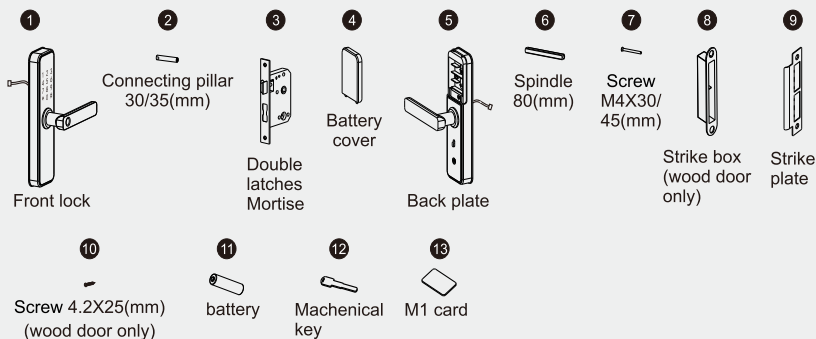

2. Door opening direction

① Right handle opening

Right inwards

Inside

Outside

Right outwards

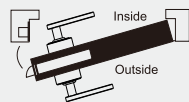

② Left handle opening

Left inwards

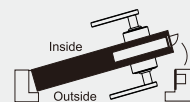

Left outwards

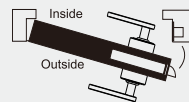

3. Shift the left and right

According to your needs to adjust the left and right by a screw driver to release screw, then turn the handle 180 degree, then fix the screw.

Note: Do not unscrew the screw in the handle hole, if there is broken when you do that, you will not have any warranty.

Front panel

Back panel

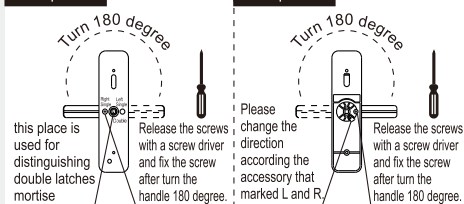

Right

Left

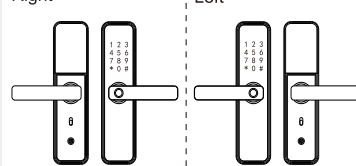

Right Opening

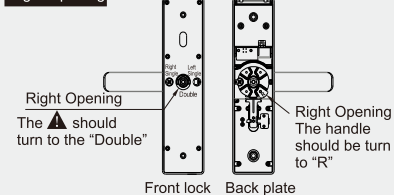

Left Opening

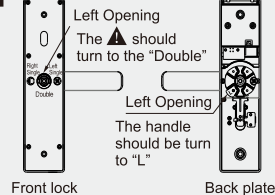

4. Adjust the mortise direction

According to the your need to adjust the mortise direction.

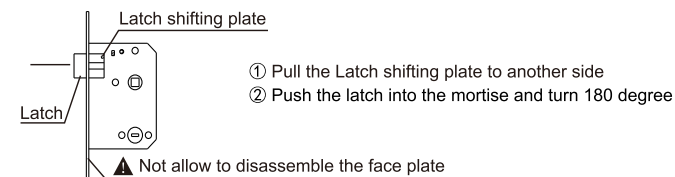

5. Accessories for sorts of door thickness

Available door thickness 35mm-55mm. If the door is over this range, please contact us for more information. Please select the correct accessories according to your door thickness.

Code and name	Specifications(mm)	door thickness ranges & QTY	
		35≤M≤40(mm)	41≤M≤55(mm)
⑥ Spindle 80(mm)	80	1	1
⑩ Screw 4.2X25(mm) (wood door only)	25 4.2	4	4
⑩ Screw M4X30/45(mm)	30 M4	1	
	45 M4	1	2
② Connecting pillar 30/35(mm)	30	1	
	35	1	2

6. Caution before installation

- Do not be a strong force when installation, avoid to damaging the lock.
- Use correct installation tools.
- Wear glass to protect your eyes when drilling holes.
- Drilling the door holes on both side of the door avoiding to damaging the door plate.

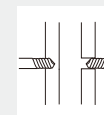
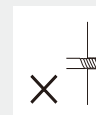
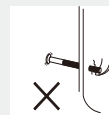

7. Installation

Installation steps:

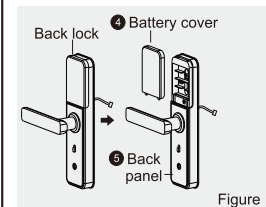

(1) As Figure 1:
① Divide the Back Lock into Battery cover and Back panel.

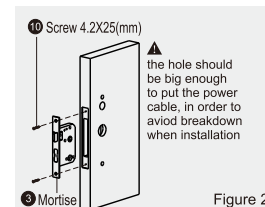

(2) As Figure 2:
① Make the mortise cable get through the door plate, fix the mortise with 2 screws.

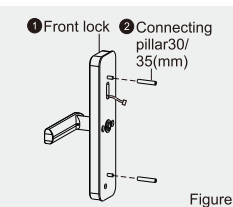

(3) As Figure 3:
① Fix the two connecting pillars on the front panel

7. Installation

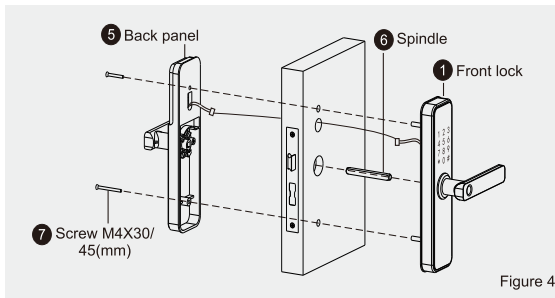

Figure 4

(4) As Figure 4:

- ① Put the spindle on the mortise.
- ② Make the front panel cable across to the door plate and connect to the back panel.
- ③ fix the front panel and back panel with two screws.

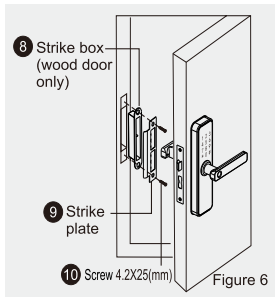

Figure 6

(6) As Figure 6:

- ① Install the strike box and strike plate on the door frame with 2 screws.
(Note: this no strike box for steel door frame)
- ② Test the lock if it works correctly.

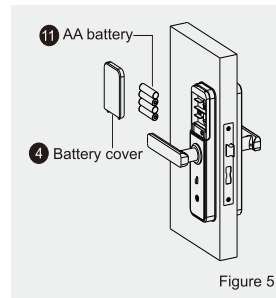

Figure 5

(5) As Figure 5:

- ① Put the Batteries correctly and fix the Battery cover.

8. Check points after installation

- ① The face plate is horizontal with the door.
- ② The Latch bolt, Dead bolt and Security Bolt must works smoothly and flexibly.
- ③ The Front lock is vertical and stable.

1.installation

- a. Professional installation recommended
- b. Pay attention to the connecting cable during installation
- c. Please adjust the handle direction according to the instructions.
- d. It is necessary to keep the door half open during installation
- e. After installation, please check whether fingerprint, password, IC card, key, internal and external handle, and anti lock switch can work normally.
- f. If it can't be used normally check for improper installation.

2. Installation diagram

5050 Lock body

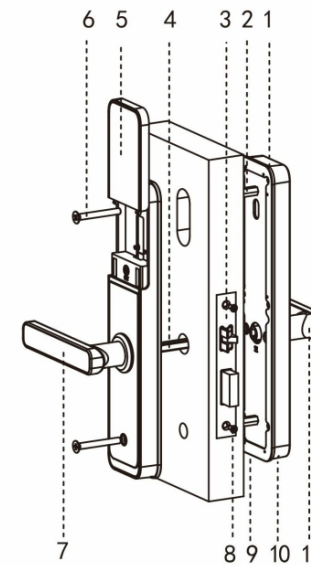

6052 Lock body

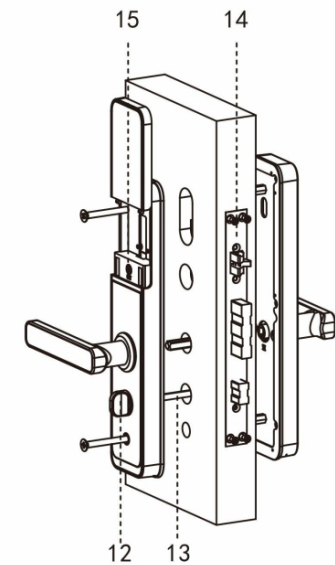

- | | | |
|-------------------------------|--------------------------|----------------------|
| 1.Outer panel | 2.Connecting column | 3.lock body |
| 4.Square bar | 5.Battery case cover | 6.Connecting screw |
| 7.Back handle | 8.Lock body fixing screw | |
| 9.Emergency power supply port | | 10.Lock core |
| 11.Front handle | 12.knob | 13.Anti lock pick up |
| 14.Lock body(6052) | | 15. Setting key |

3 Confirm the direction of the handle

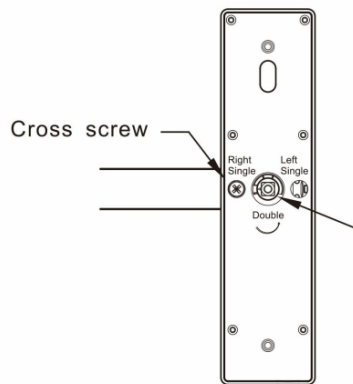
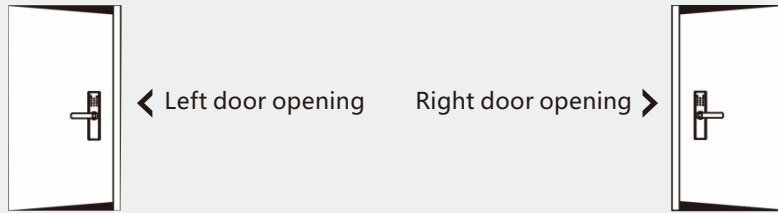

Change direction of the handle

1. Remove the cross screw in the figure, Turn the handle 180 degrees in the direction of the arrow.
2. After adjusting the handle direction, install the screw and complete the reversing

Attention: hexagon socket screw is fixed when changing the handle direction. The triangle symbol should be turn it around and corresponding "double" position.

4. Cutout

Refer to the hole drawing and the lock body model.

5. Install the lock body:

5.1 Support lock body model: 5050, 4585, 6085, 5572, 6072

6052, ball lock, etc.

5.2 Adjust the direction of the diagonal tongue according to the direction of the door.



Left inside open
Right outside open



Right inside open
Left outside open

5.3 Lock body reversing

5050 lock body

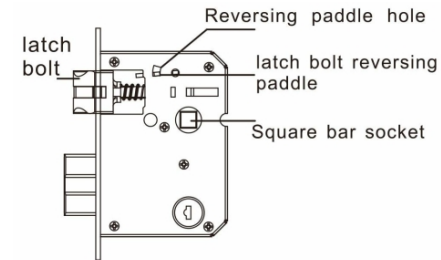

- a. Pull the reversing paddle of locking tab to the other end.
- b. Push the oblique tongue into the lock body and rotate 180 degrees.
- c. Release reversing paddle.
- d. Install the lock into the door frame
Tighten the fixing screw of lock body.

5572 lock body

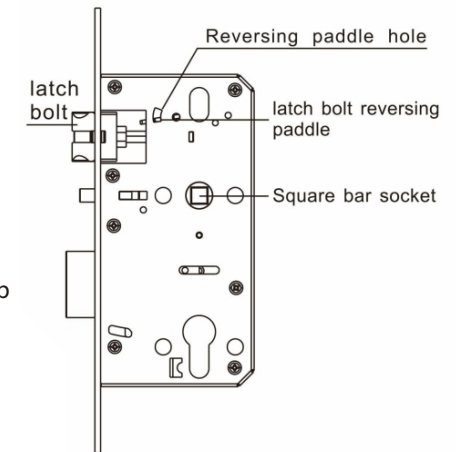

6. Door lock installation

6.1 Connect the two corresponding studs on the outer plate

6.2 Fixed outer panel

a. Insert the square bar into the square bar hole

b. Pull the main board connecting cable into the door

c. Align the outer panel with the opening position and install the square bar

6.3 Fixed inner panel

a. Connect the main board connecting cable, and put the redundant cable into the slot.

b. Insert the anti lock paddle. The length of the paddle can be cut according to the thickness of the door (6052 lock body only)

c. Align the square bar of the inner panel and compress the inner panel.

b. Lock the screws and fix the panel.

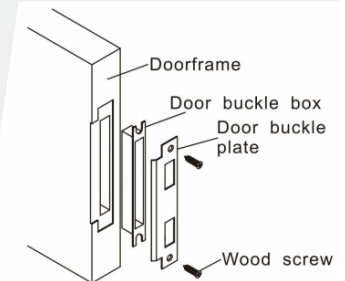

7. Install the door buckle plate and buckle box

Intelligent lock(five in one) operation manual

1.Function and Operation

- 1) Administrator Information: Administrator's password / Fingerprint
- 2) Unlock information: the input fingerprint, password , APP or IC card (including Administrator and ordinary users)
- 3) [*] : Clear / Back Key
- 4) [#] : Confirmation / Menu Function Key

2. Original state

- 1) The original password of the factory is 123456, and any fingerprints can be opened.
- 2) Any fingerprint, IC card ,or password which are not registered can't open the lock after inputting the administrator information.

3. Lock function management (step one)

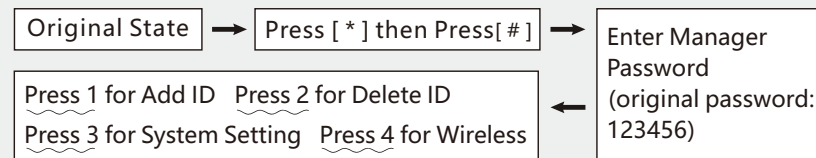

4. Add ID

1) Add Administrators

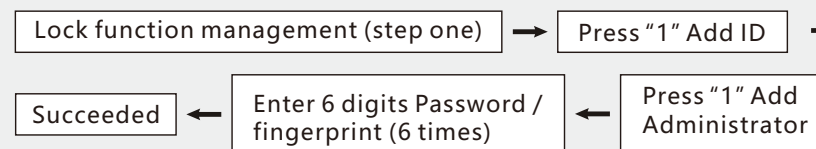

2) Add Normal ID

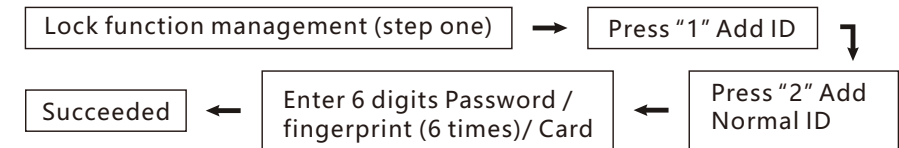

5. Delete ID

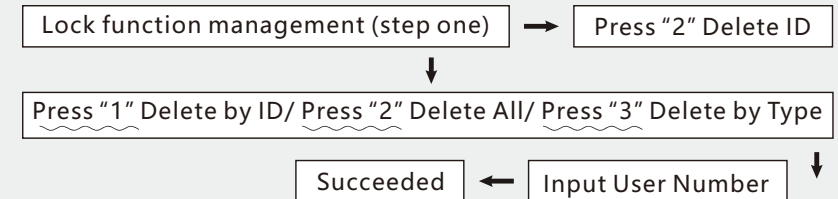

6. System Setting

1) Voice & Language

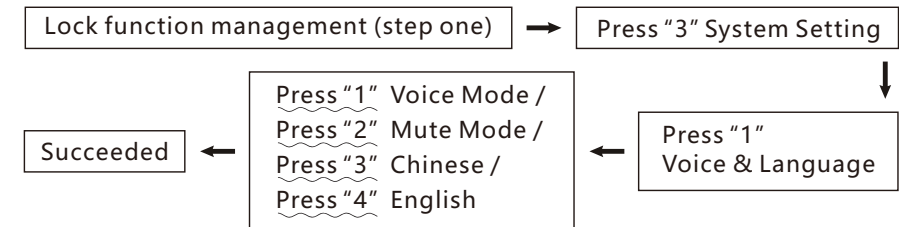

2) Time Setting



3) Set Unlock Mode

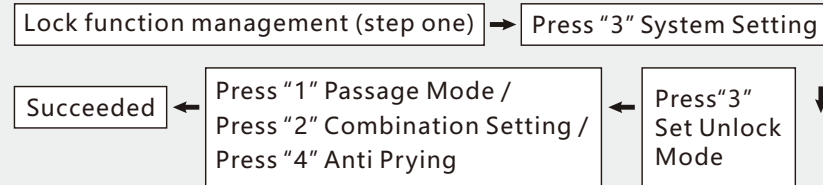

4) Query Information

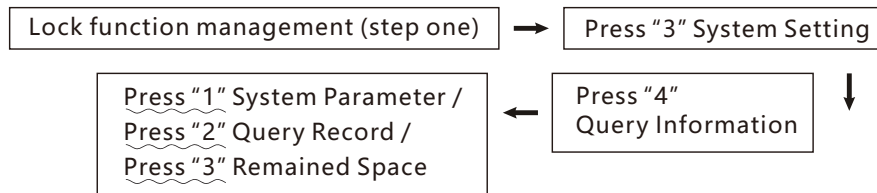

7. Wireless Setting

2) Time Setting

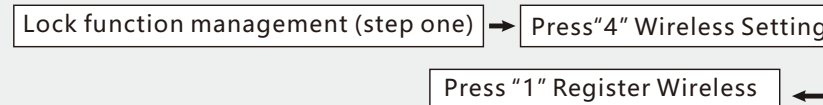

APP Configuration (Tuya Smart)

- 1) Download the Tuya app in the app store.
- 2) Register with your phone number and log in.

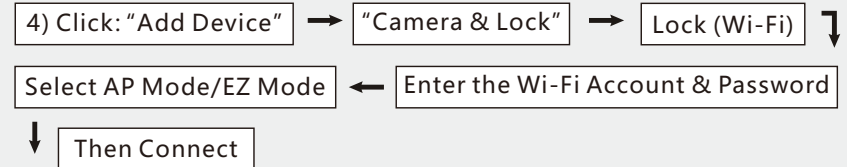
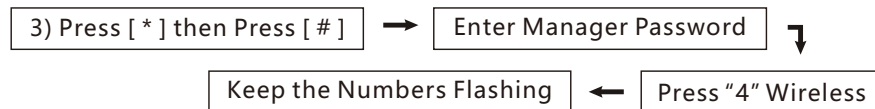

Technical Parameters

1	items	Parameters	Memo
2	Static current	≤50uA	
3	Dynamic current	≤180mA	
4	Administrators number	9	
5	Fingerprint number	100	
6	Fingerprint+password+card capacity	300	
7	Fingerprint Sensor	Semiconductor	
8	Fingerprint contrast time	≤0.6Second	
9	Fingerprint identification Angle	360°	
10	False Rejection Rate	≤0.1%	
11	False Recognition Rate	≤0.0001%	
12	Reaction time	≤0.1Second	
13	Power type	6V	
14	Emergency power	5VDC	
15	Working temperature	-25C~60° C	
16	Working Relative Humidity	20%~90%RH	
17	Human voice	Yes	
18	Keyboard	Touch standard 12-bit keyboard	
19	Password Length	6 digits	
20	Phantom password	32digits	
21	Low voltage alarm	4.6+0.2V	
22	Unlock time	≤1Second	