

Keliss

Dear customer:

Thank you for choosing Keliss Smart Mirror!

Embed with exquisite workmanship and engineering techniques, based on high-quality standards of production, Keliss Smart Mirror thrives in the modern smart home industry. However, the products still need certain care and maintenance for a better user experience.

How to clean a mirror?

1. Dip a piece of lint-free cloth with warm water and wring it out, wipe the mirror surface, and then wipe out the remaining water with another piece of dried cloth.
2. Do not spray the cleaners directly on the mirror, simply apply it to the cloth or mix it with the warm water.
3. Use neutral cleaners instead of acid or alkali ones, also avoid using abrasive cleaners which can cause damage to all parts of a mirror.

Note: The cleaners should not include ammonia.

If you follow all the simple procedures above, your smart mirror will always look stunning as brand-new!

Sincerely,
Keliss



Keliss

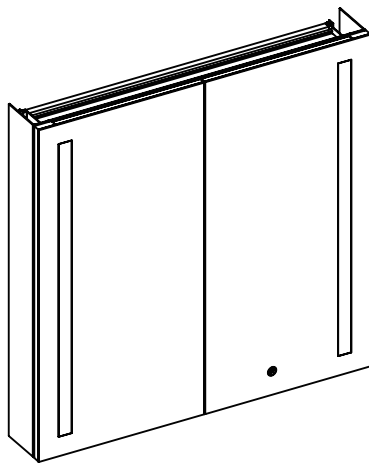

MTM0XXXXSS

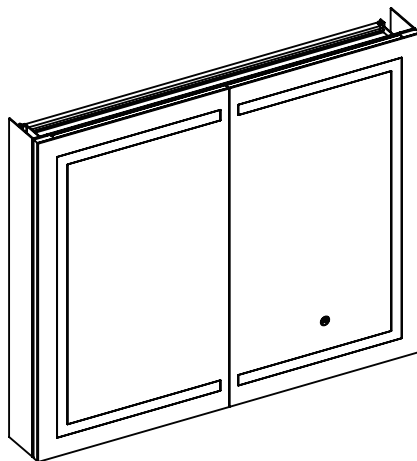

MTM1XXXXSS

LED MIRROR INSTALLATION GUIDE



Please read the information below before using



WARNING

To reduce the risk of burns, fire, electric shock, or injury to people, please use this furnishing only for its intended purpose as described in these instructions.

Do not use any attachments that are not recommended by the manufacturer.



WARNING

Never drop or insert any objects into any of the openings.

This product is for indoor use only and should not be used outdoors.

Risk of electric shock. Connect this furnishing to a properly grounded circuit only. See Grounding instructions.



WARNING GROUNDING INSTRUCTIONS:

This product must connect to a grounded metal, permanent wiring system, or an equipment-grounding conductor must run with the circuit conductors and be connected to the equipment-grounding terminal or lead on the product.

An Electrical option cabinet must be wired to a 20 Amp GFI (Ground Fault Interrupter) protected circuit when used in bathrooms and all other locations required by the National Electric Code.

PLEASE SAVE THIS USER MANUAL FOR FUTURE REFERENCE

LED CABINET INSTALLATION GUIDE



TOOLS REQUIRED FOR ASSEMBLY

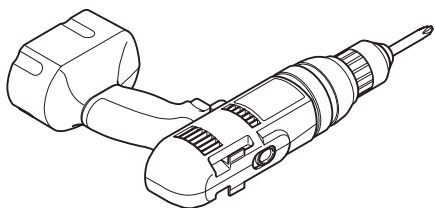

Electrical Drill

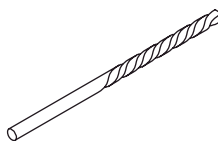

1/8" Drill Bit

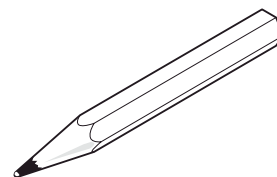

Pencil



Phillips
Screwdriver

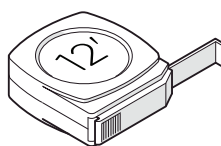

Tape Measure

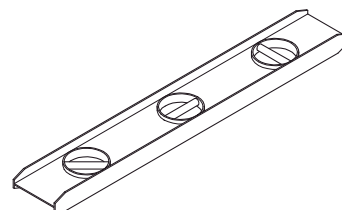

Level

PARTS INCLUDED

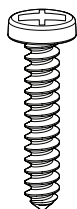

SCREW
(x7)

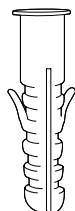

WALL PLUG
(x7)

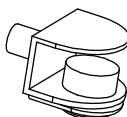

(x12)

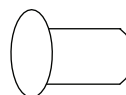

(x8)

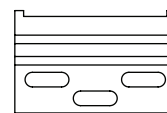

(x2)

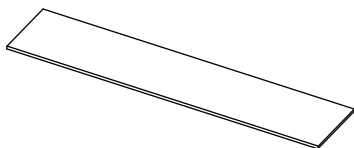

(x3)

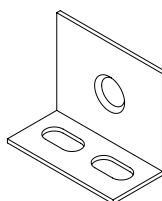

(x1)

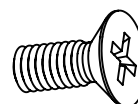

(x2)



(x6)



NOTE: Determine overall mirror dimensions before proceeding to installation.

*All dimensions & specifications are approximate and subject to change without notice.

LED CABINET INSTALLATION GUIDE



ELECTRIC CONNECTIONS

ALL WIRING SHOULD BE DONE BY A QUALIFIED LICENCED ELECTRICIAN



WARNING: Shut off power before wiring the mirror.



WARNING: An Electrical option mirror must be wired to a 20 Amp GFI (Ground Fault Interrupter) protected circuit when used in bathrooms and all other locations required by the National Electric Code.



WARNING: This mirror must connect to a grounded metal permanent wiring system or an equipment-grounding conductor must be run with the circuit conductors and connected to the equipment-grounding terminal or lead on the mirror.



CAUTION: Requires 120 VAC 20 Amp GFI protected circuit.

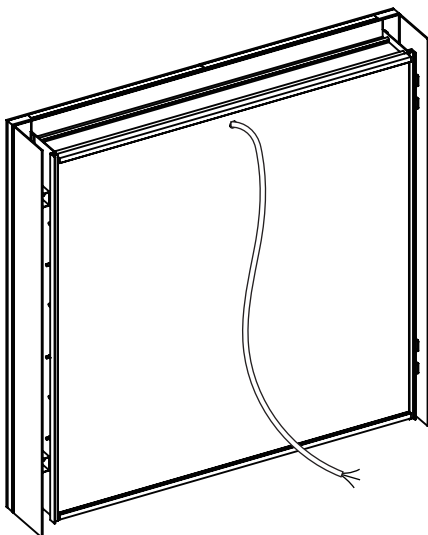

Electric wiring: Be sure to provide enough wire to make the proper and safe connection to the Field/Power.

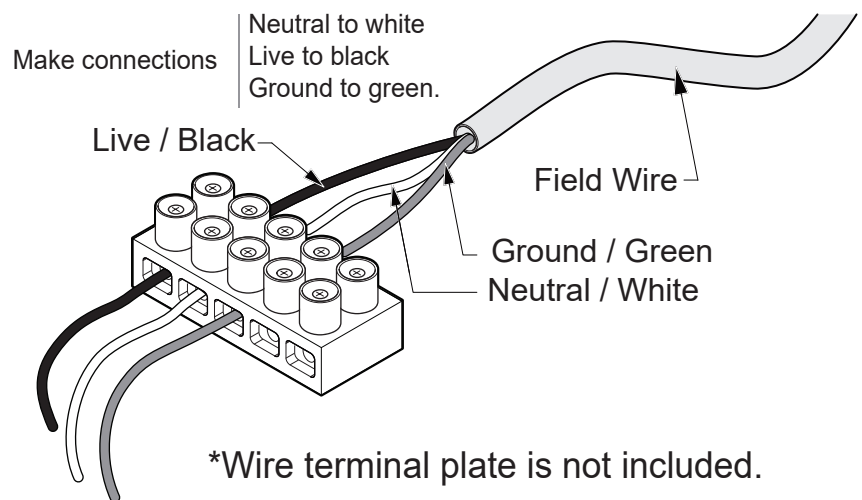

MIRROR FEATURES

- 5mm copper free silver mirror
- High output LED lighting:
CRI 90+, 2700-6500K CCT, IP44
- Color Temperature changing touch switch
for surface LED
- Defogger

WALL HUNG INSTALLATION

1 PLACEMENT

Select the desired position of the cabinet.
Level and mark the location.

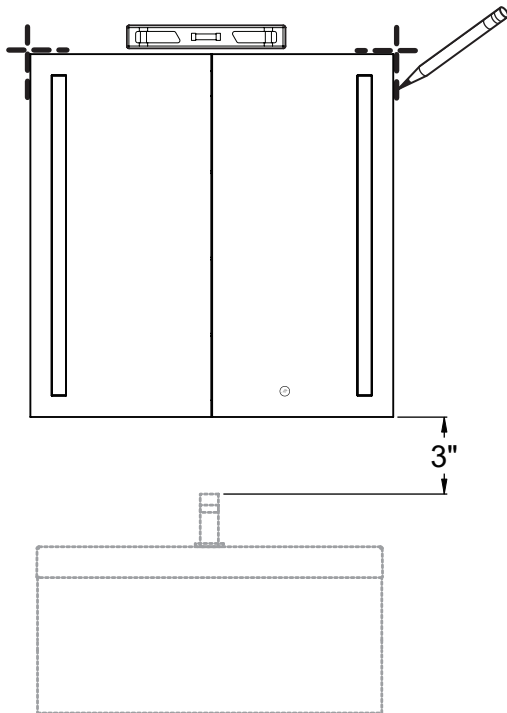

2 SUPPORT LOCATION

Measure the center of the holes and mark the drilling locations to ensure markings are leveled.

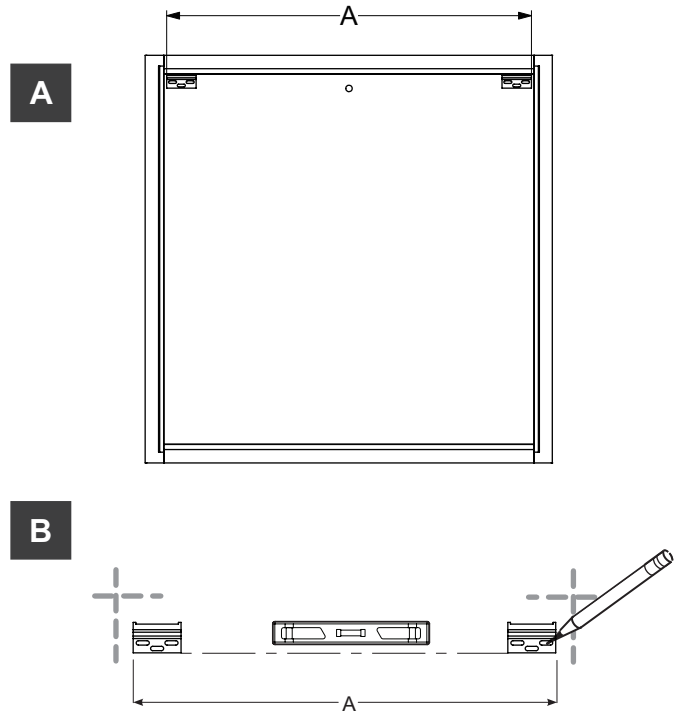

3 INSTALL SCREWS

Make holes with a drill and fill them with the supplied plugs and screws. Leave a gap of 2-3mm between the head of the screw and the wall.

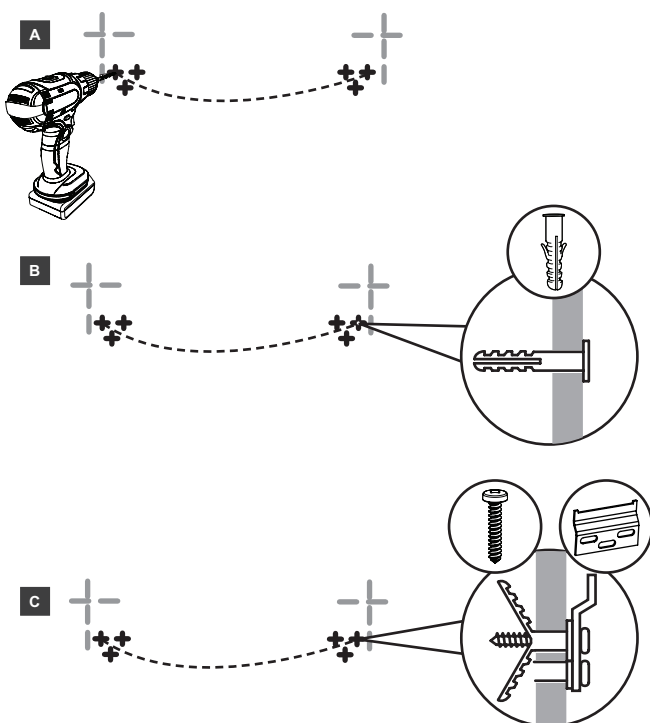

4

Using the two provided screws, install the bracket onto the bottom of the cabinet.

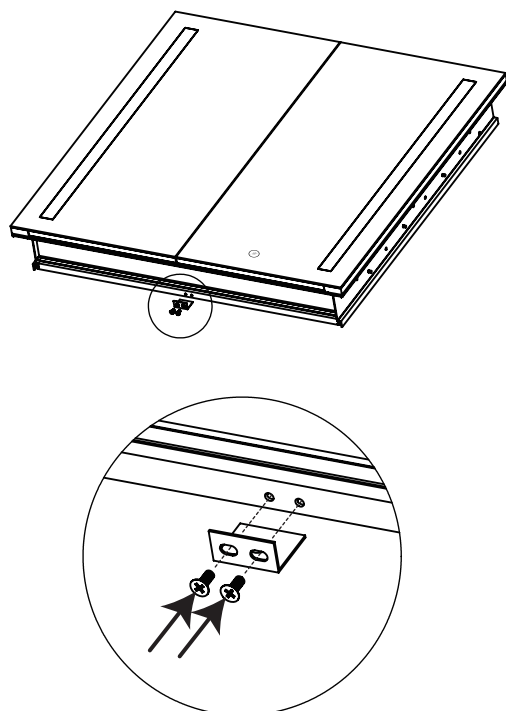

WALL HUNG INSTALLATION

- 5** Hang the cabinet on the cleats and check the level, adjust horizontally to desired location. (This may require two people)

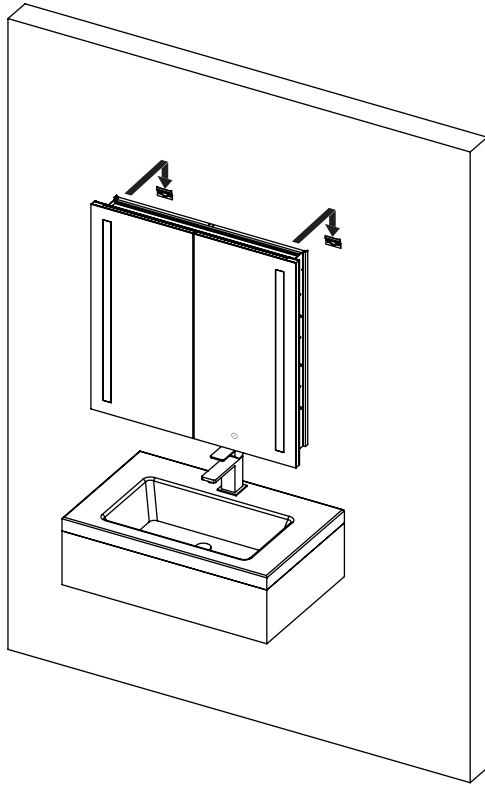

- 6** Mark the location of the bottom bracket on the wall with a pencil.

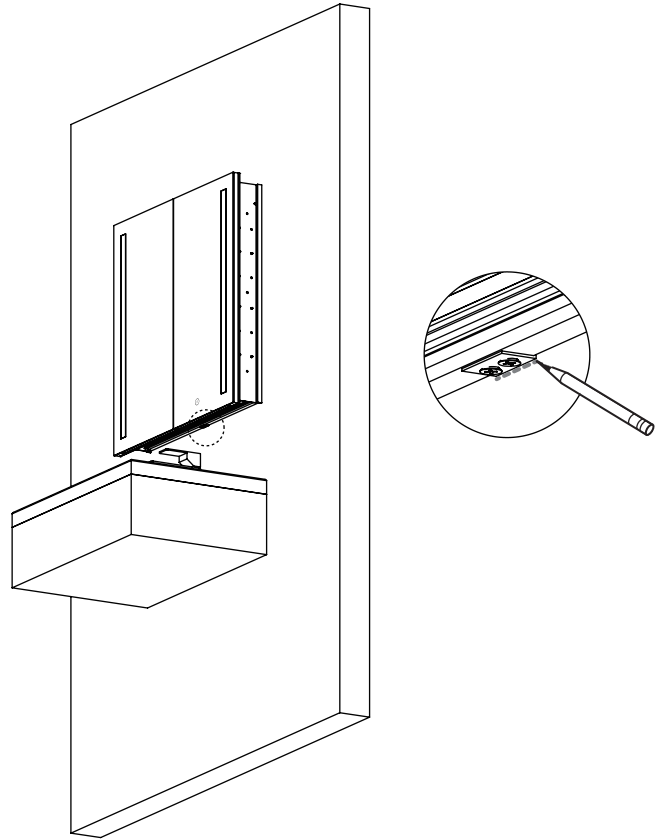

- 7** Lift and remove the cabinet from the wall to reveal the pencil mark location of the bracket.

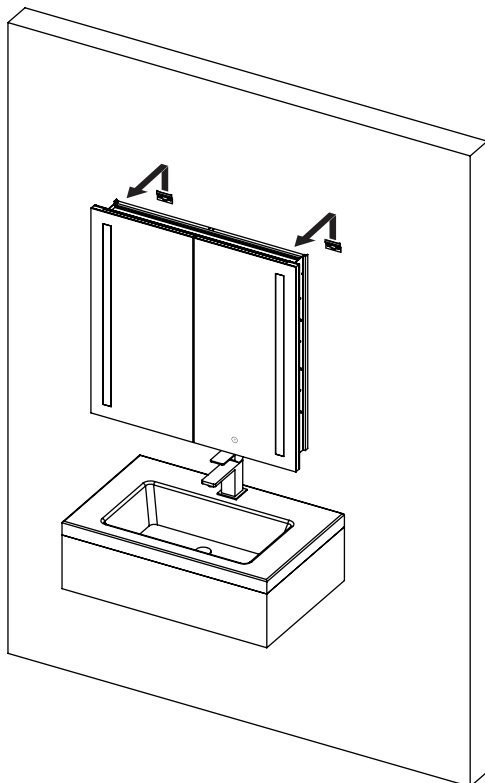

- 8** Uninstall the bracket from the mirror by removing the two screws previously installed during step 4.

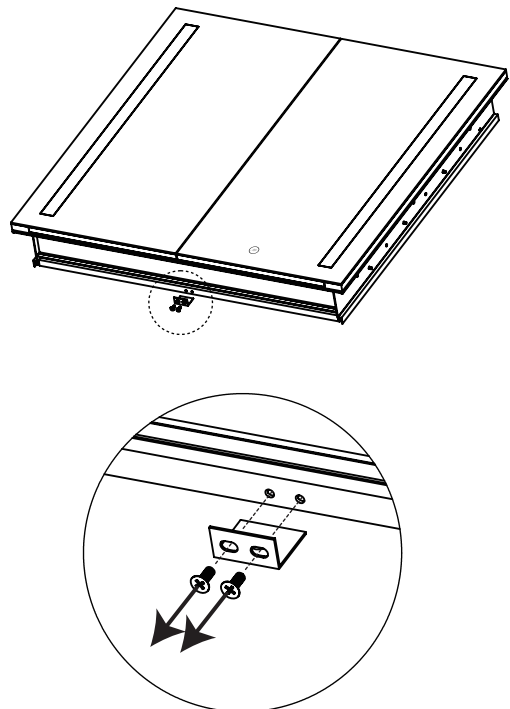

WALL HUNG INSTALLATION

9

Using the screw provided, mount the bracket to the wall at the marked pencil location. Do not over-tighten

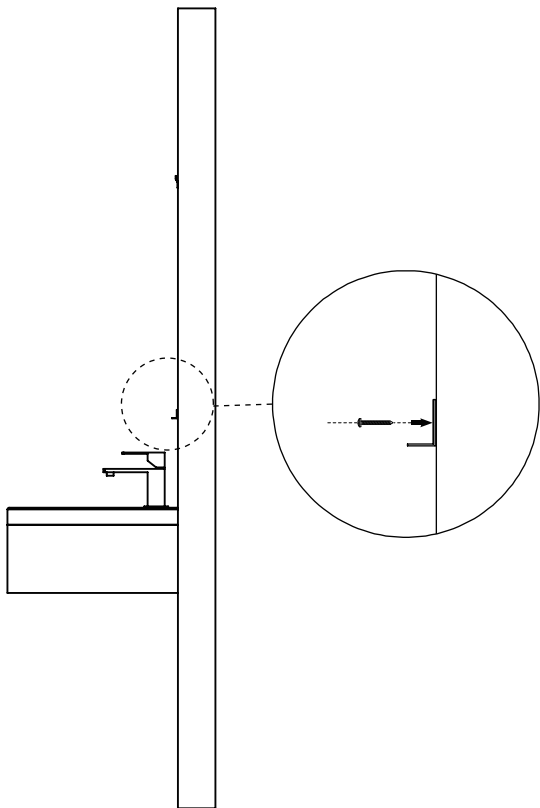

10

Lift the cabinet and carefully lower it onto the cleats and adjust horizontally.

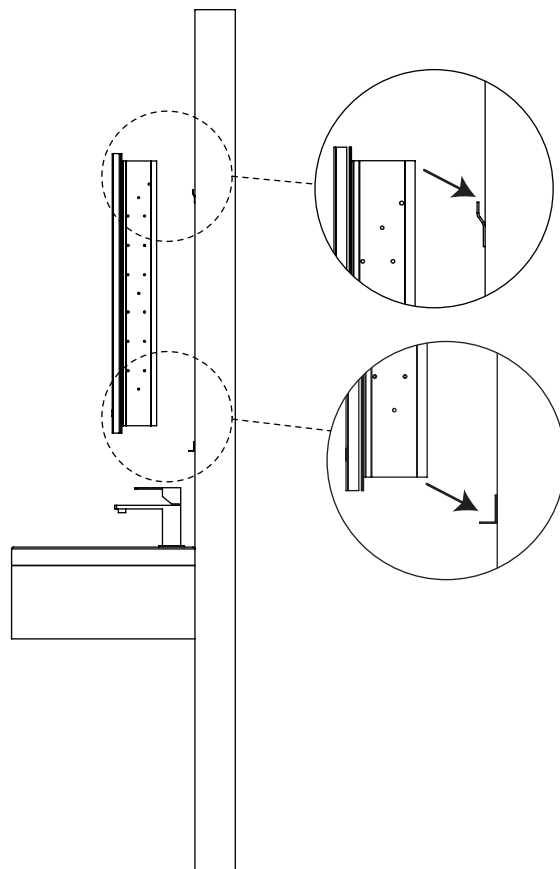

11

Using the screws provided, align the lower bracket and attach it to the cabinet.

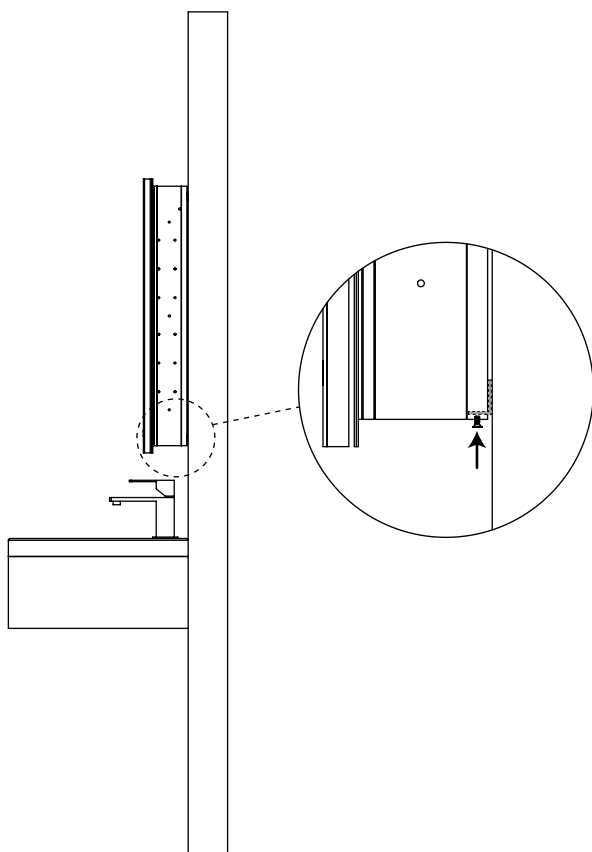

12

Install side mirror.

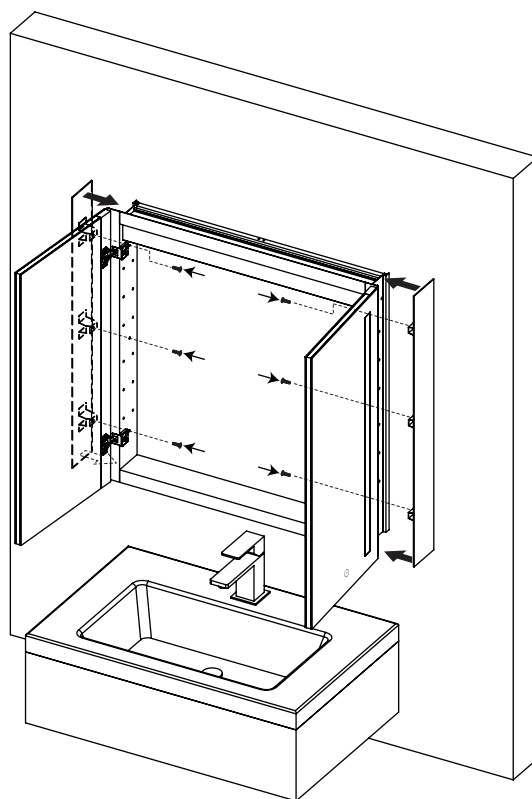

WALL HUNG INSTALLATION

13

Install clamps to hold the glass shelf, and install the shelf.

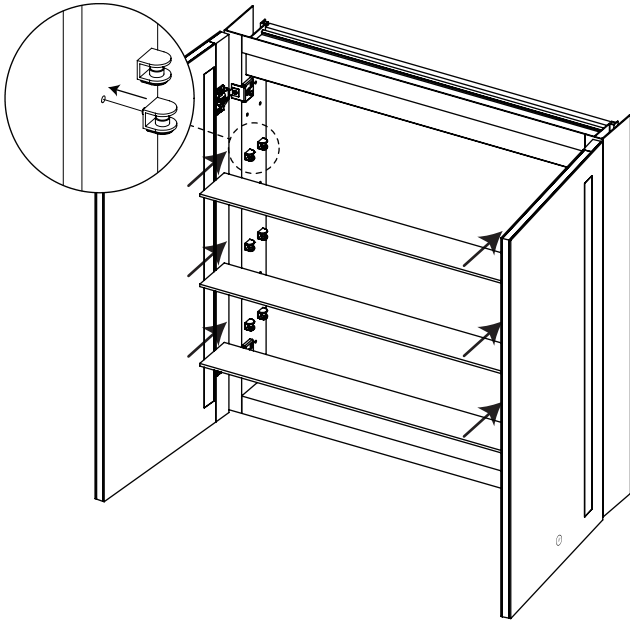

14

Secure the position of the glass shelf.

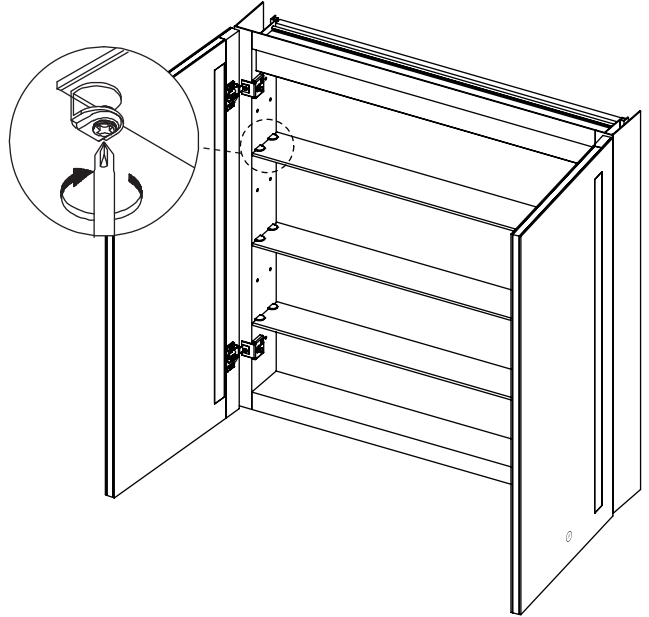

15

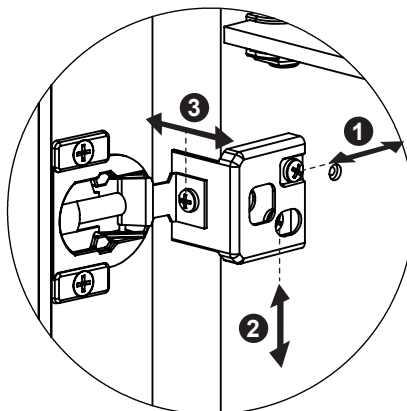
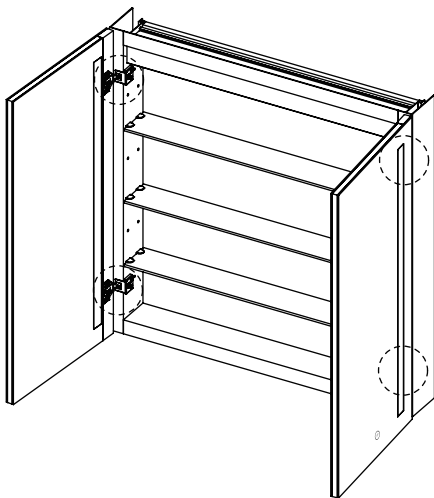

1. Move door away/towards the cabinet.

This must be adjusted first to prevent scratching the surface of the aluminum cabinet.

2. Move door(s) up/down

3. Move door(s) left/right

RECESS INSTALLATION

- 1** Measure the size of the cabinet mounted inside the wall.

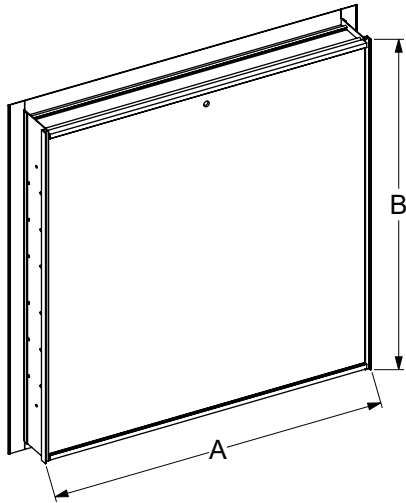

- 2** Draw the dimension of the cabinet on the wall.

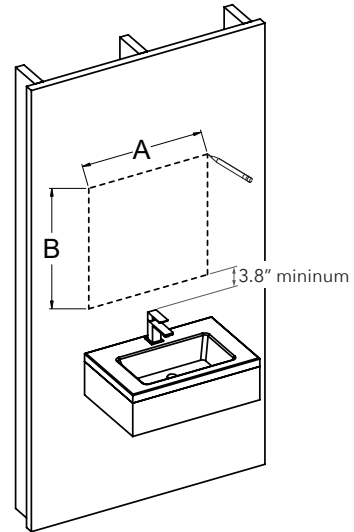

- 3** Dig out the mounting holes for the installation of the mirror cabinet.

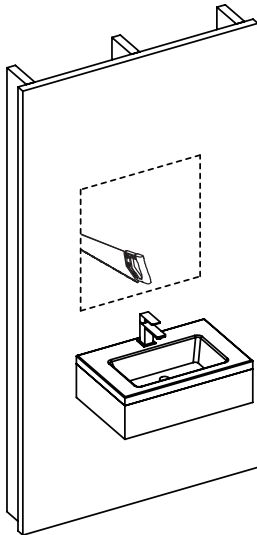

- 4** Cut the marked dimension with a suitable tool.

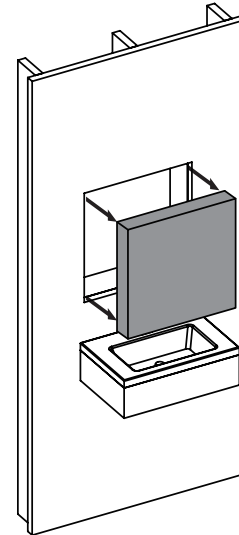

- 5** Frame the opening for the cabinet based on the measurements.

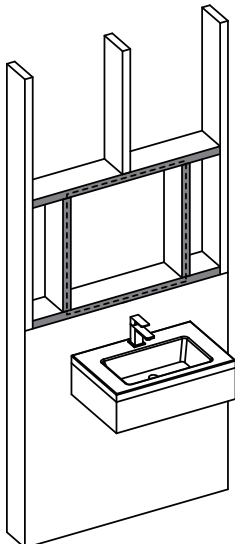

- 6** Connect electrical wires before inserting the cabinet into the opening.

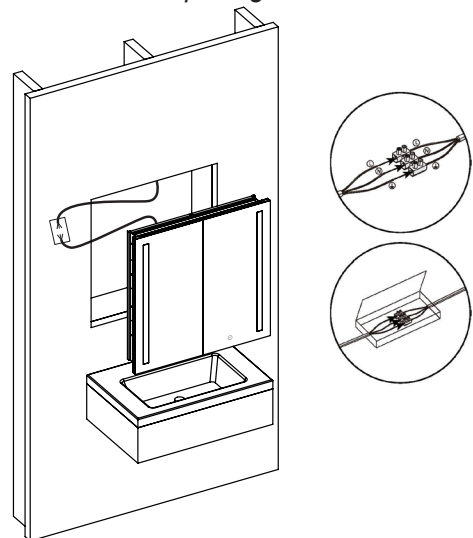

RECESS INSTALLATION

7

Position cabinet in cut-out opening.

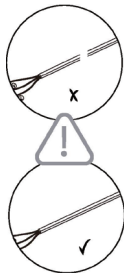
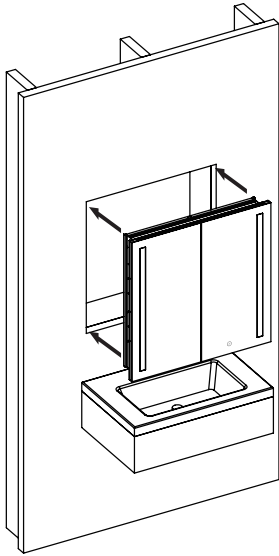

Be careful to avoid squeezing the wiring while insert the cabinet.

8

Affix using hardware screws into the studs.

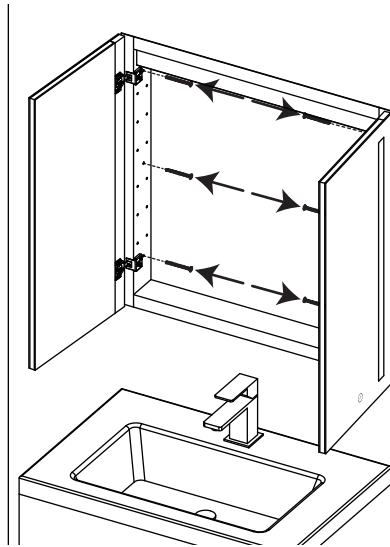

9

Install clamps to hold the glass shelf, and install the shelf.

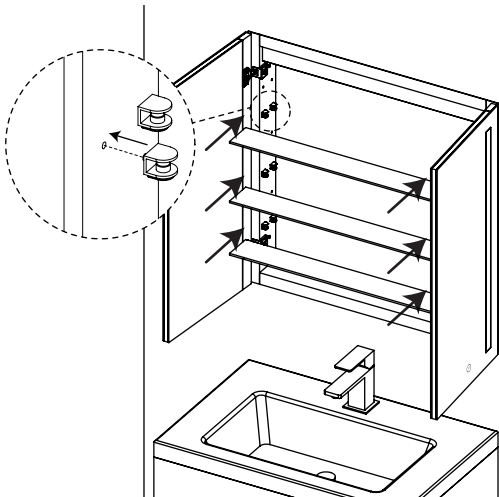

10

Secure the position of the glass shelf.

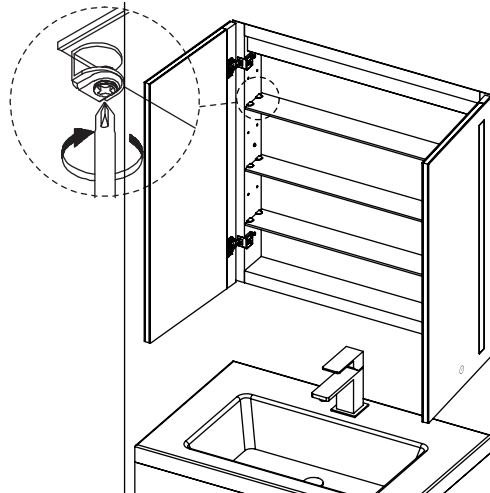

11

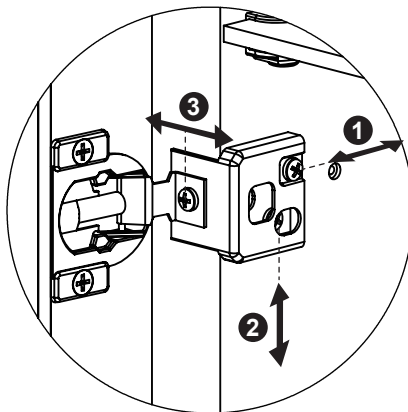
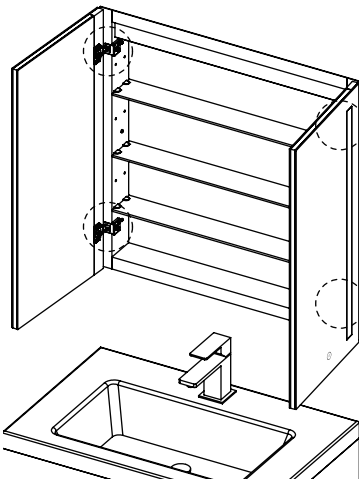

1. Move the door away/ towards the cabinet.
This must be adjusted first to prevent scratching the surface of the aluminum cabinet.

2. Move door(s) up/down

3. Move door(s) left/right

FINAL ASSEMBLY

How to use Defogger Switch and Dimmer Switch:

Single button touch switch

Touch  to turn the task light and defogger on or off.

Press and hold  to change the color temperature of the task light.

Double buttons touch switch

Touch  to turn the task light on or off.

Touch  to turn the defogger on or off.

Press and hold  to change the color temperature of the task light.

Press and hold  to dim or brighten the task light.

3 buttons touch switch

Touch  to turn the task light on or off.

Touch  to cycle color temperature.

Press and hold  to change the color temperature of the task light.

Touch  to turn the defogger on or off.

Press and hold  to dim or brighten the task light.